

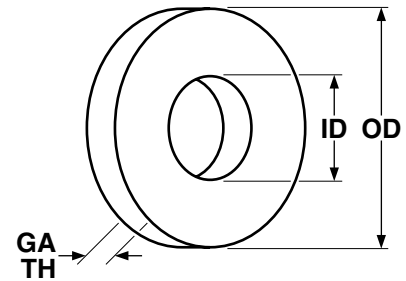

# Washers

## USS Flat Washers



Bolt Size	Outside Diameter			Inside Diameter			Thickness		
	Nominal	Max	Min	Nominal	Max	Min	American Standard (Gauge)	Max	Min
3/16	9/16	0.577	0.557	1/4	0.265	0.245	18 (3/64)	.065	.036
1/4	3/4	0.749	0.727	5/16	0.327	0.307	16 (1/16)	.080	.051
5/16	7/8	0.905	0.868	3/8	0.390	0.370	14 (5/64)	.104	.064
3/8	1	1.030	0.993	7/16	0.453	0.433	14 (5/64)	.104	.064
7/16	1-1/4	1.280	1.243	1/2	0.515	0.495	14 (5/64)	.104	.064
1/2	1-3/8	1.405	1.368	9/16	0.577	0.557	12 (7/64)	.132	.086
9/16	1-1/2	1.499	1.462	5/8	0.640	0.620	21 (7/64)	.132	.086
5/8	1-3/4	1.780	1.743	11/16	0.718	0.681	10 (9/64)	.160	.108
3/4	2	2.030	1.993	13/16	0.842	0.805	9 (5/32)	.177	.122
7/8	2-1/4	2.280	2.243	15/16	0.968	0.931	8 (11/64)	.192	.136
1	2-1/2	2.530	2.493	1-1/16	1.092	1.055	8 (11/64)	.192	.136
1-1/8	2-3/4	2.780	2.743	1-1/4	1.280	1.243	8 (11/64)	.192	.136
1-1/4	3	3.030	2.993	1-3/8	1.405	1.368	8 (11/64)	.192	.136
1-3/8	3-1/4	3.295	3.240	1-1/2	1.545	1.490	7 (3/16)	.213	.153
1-1/2	3-1/2	3.545	3.490	1-5/8	1.670	1.615	7 (3/16)	.213	.153
1-5/8	3-3/4	3.795	3.740	1-3/4	1.795	1.740	7 (3/16)	.213	.153
1-3/4	4	4.045	3.990	1-7/8	1.920	1.865	7 (3/16)	.213	.153
1-7/8	4-1/4	4.295	4.240	2	2.045	1.990	7 (3/16)	.213	.153
2	4-1/2	4.545	4.490	2-1/8	2.170	2.115	7 (3/16)	.213	.153
2-1/4	4-3/4	4.795	4.740	2-3/8	2.420	2.365	5 (7/32)	.248	.193
2-1/2	5	5.045	4.990	2-5/8	2.670	2.615	4 (15/64)	.280	.210
2-3/4	5-1/4	5.315	5.240	2-7/8	2.940	2.865	3 (1/4)	.310	.228
3	5-1/2	5.565	5.490	3-1/8	3.190	3.115	2 (5/32)	.327	.249

ANSI B18.22.1

**The value-added source for quality bolts, screws, nuts, washers and other industrial fasteners.**

3211 West 9th Street, Trainer, PA 19061-5242 TOLL FREE: 1-800-662-7459 LOCAL: 610-485-5700 FAX: 610-485-5877

E-MAIL: [sales@coburnmyers.com](mailto:sales@coburnmyers.com)